

Install Manual

HSF1-40-100-275

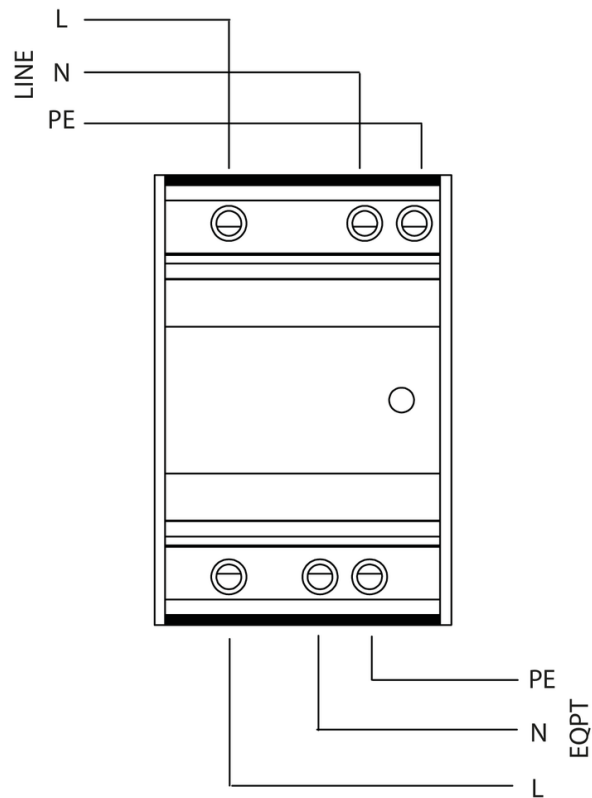

Installation



Alarm

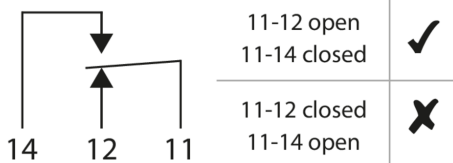

Terminal information

Terminal Type		
min Capacity	2.5 mm ²	0.5 mm ²
max Capacity	16 mm ²	2.5 mm ²
Torque	2 Nm	0.6 Nm
Wire Striping Length		

Mounting information

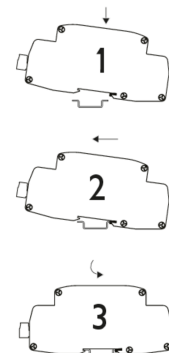

Dimensions

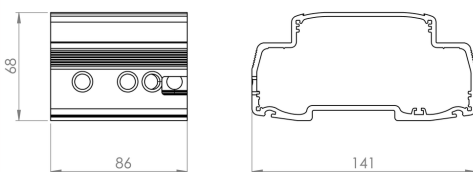

Specifications

Electrical Specifications

Connection type		Series
Modes of protection		L-N, L-PE, N-PE
Nominal voltage	U_0	230VAC
Short circuit withstand level	I_{SSCR}	25kA

Mechanical Specifications

Minimum operating temperature		-40°C
Maximum operating temperature		70°C
Minimum operating humidity		5%
Maximum operating humidity		95%
Mounting method		TS35 DIN Rail
Environmental rating		IP20
Length		141mm
Width		86mm
Height		69mm