

## Install Manual

## HSF3-40-100-275

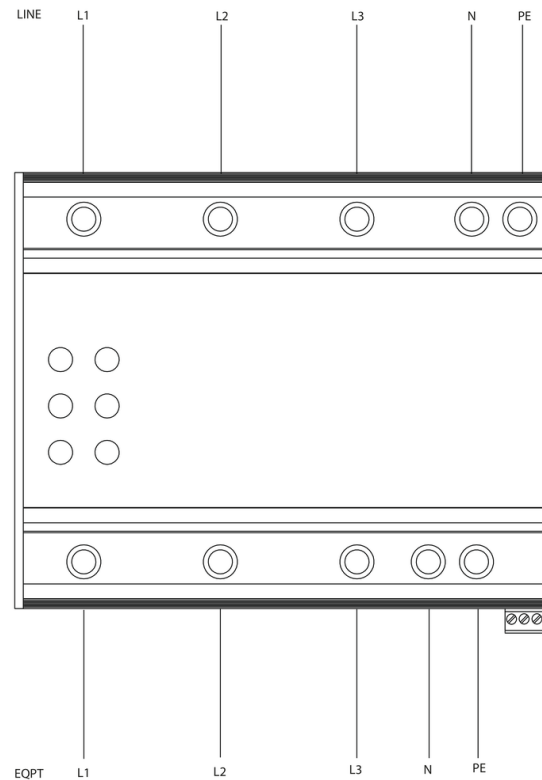

## Installation



## Dimensions

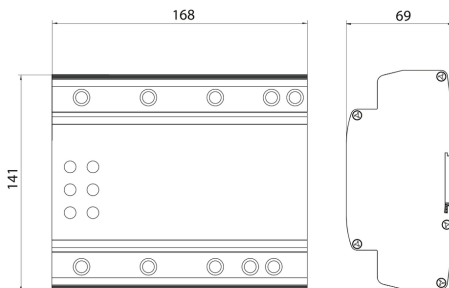

## Terminal information

## Terminal Type

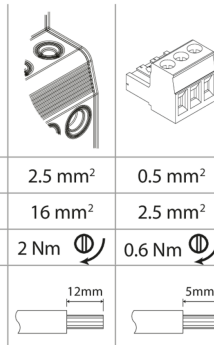

min Capacity	2.5 mm <sup>2</sup>	0.5 mm <sup>2</sup>
max Capacity	16 mm <sup>2</sup>	2.5 mm <sup>2</sup>
Torque	2 Nm	0.6 Nm
Wire Striping Length	12mm	5mm

## Mounting information

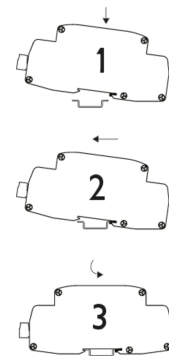

## Specifications

## Electrical Specifications

Connection type		Series
Modes of protection		L-N, L-PE, N-PE
Nominal voltage	U <sub>0</sub>	230VAC
Short circuit withstand level	I <sub>SSCR</sub>	25kA

## Mechanical Specifications

Minimum operating temperature		-40°C
Maximum operating temperature		70°C
Minimum operating humidity		5%
Maximum operating humidity		95%
Mounting method		TS35 DIN Rail
Environmental rating		IP20
Length		141mm
Width		168mm
Height		69mm